

subject to technical alterations

type: H
range: .40 - 1.20 INCH
range of indication: .38 - 1.22 INCH
digital step: -
scale interval: .0005 INCH
measuring force: 1,1 - 1,6 N
weight: 180 g

acceptable deviations
VDI/VDE/DGQ 2618 Bl. 12.1/13.1)
max. permissible
errors "G": .0015 INCH
repeatability "r": .0005 INCH
reference temperature: 20° C
operation temperature: 10° C - 30° C
storage temperature: -10° C - 50° C

scale: 1:1
drawing-nr.: DAB-H710_KR_I
date of issue: 14.01.09
name: T.Koenig
revision status:
revision date:

groove depth A [mm]	measuring range Meb [mm]								
	.394	.472	.551	.630	.709	.787	.866	.984	1.181
0	0 / 3.256	0 / 3.287	0 / 3.287	0 / 3.295	0 / 3.303	0 / 3.315	0 / 3.327	0 / 3.346	0 / 3.382
.002		.067 / 3.228	.059 / 3.272	.059 / 3.276	.059 / 3.283	.059 / 3.295	.059 / 3.307	.059 / 3,327	.059 / 3.362
.003			.075 / 3.217	.071 / 3.22	.067 / 3.232	.067 / 3.24	.063 / 3.252	.063 / 3.307	.063 / 3.339
.005				.079 / 3.008	.075 / 3.232	.071 / 3.256	.071 / 3.268	.067 / 3.283	.067 / 3.319
.006					.091 / 2.051	.079 / 2.787	.075 / 3.228	.071 / 3.264	.071 / 3.299
.007						.102 / 1.677	.087 / 2.795	.079 / 3.256	.075 / 3.287
.008						.157 / .563	.130 / .941	.114 / 3.232	.091 / 3.276
	B / L								

B = minimum groove width [mm]
 maximum usable arm length [mm]

L = Example: Meb = .630 B : .071
 A = .003 L : 3.22

measuring capacity

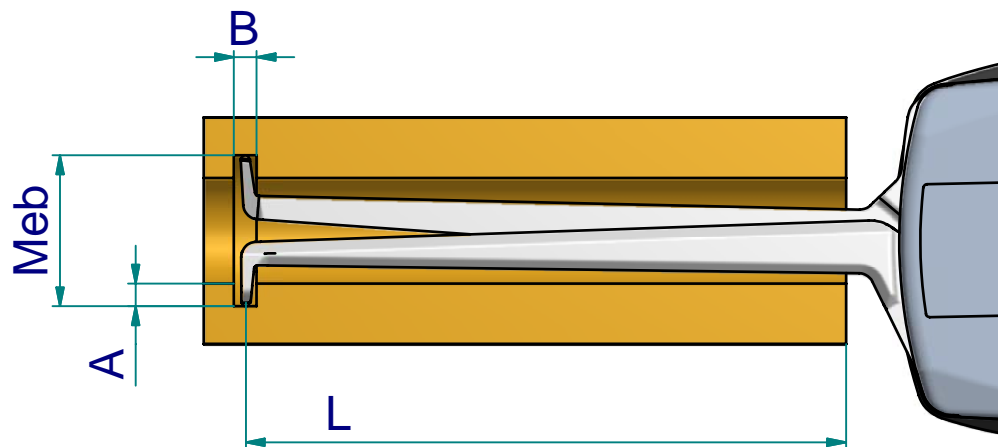

subject to technical alterations

drawing-nr.:	DAB-H710_KR_I
date of issue:	14.01.09
name:	T.Koenig
revision status:	
revision date:	